

Rich's Portable Cabins

150 Bidwell Rd, North Powder, OR

541 898-2444

www.richsportablecabins.com

Full Angus



This cabin is huge for an 8' wide, and is king when it comes to size. Simply put, this is the largest 8' wide tiny home offered by any builder of tiny homes throughout the entire nation. Combine that with amenities and you've got a tiny home that your entire family can live it.

This loft is huge and will serve as a bedroom for 3, plus the master bedroom down stairs is private and fits a queen bed with ease.

Designed to be pulled with a 1 ton or semi-truck, this cabin has the ability to be loaded with extras, including a wood stove, washer/dryer, on demand w/h, and a full sized tub to name a few.

Exterior Height: 13'6"; Width: 8'6"; Length: 40'

Interior Width: 8'; Length: 36'

Interior Living Space 288 sq ft

Weight: Approximately 14,400 lbs.

Standard features:

- 2x4 wall construction
- R-13 wall insulation
- R-19 floor insulation
- R-21 ceiling insulation
- Laminate flooring on the main level
- Laminate or vinyl in loft
- Double pane low energy efficient windows

- Hickory cabinets
- ladder accessing the loft
- Wood interior (wall and ceiling coverings)
- Two coats of lacquer wall and ceiling
- All wood Oregon style trim
- Laminate countertops
- One piece 60x32" fiberglass tub/shower
- Ceiling fan in living room
- 20" gas or electric range
- Range hood
- 9 cf 24" wide fridge
- Cedar lap exterior siding and trim stained cedar tone
- Electric heat in bathroom
- 50 amp RV power cord with 120 amp main panel service box
- Tongue on living room end

Options:

- Stacked laundry Ctr.
- Flooring: laminate (other than standard), hardwood, carpet, vinyl
- Siding: log, smart panel lap siding (painted), cedar lap (standard)
- Window panes
- Roofing color
- On-demand propane or electric water heater
- Air conditioning
- Propane RV forced air furnace
- Glass shower door
- Wood stove
- Propane fireplace
- Propane radiant heat (vented through the wall)
- Microwave/range hood
- Special appliances (black or stainless)
- 30 amp RV cord
- Holding tanks
- Split the black and gray water
- Custom window and door placement

Floor Plan

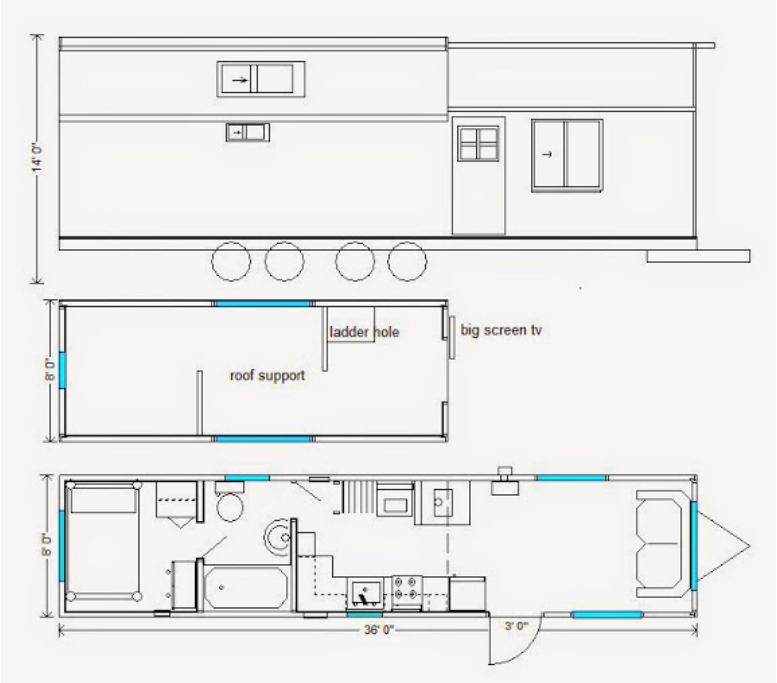

Photos



